

## First time logging into Zero clients with SSO badge

1. Tap badge to card reader.
2. The following screen should appear. (See fig. 1)

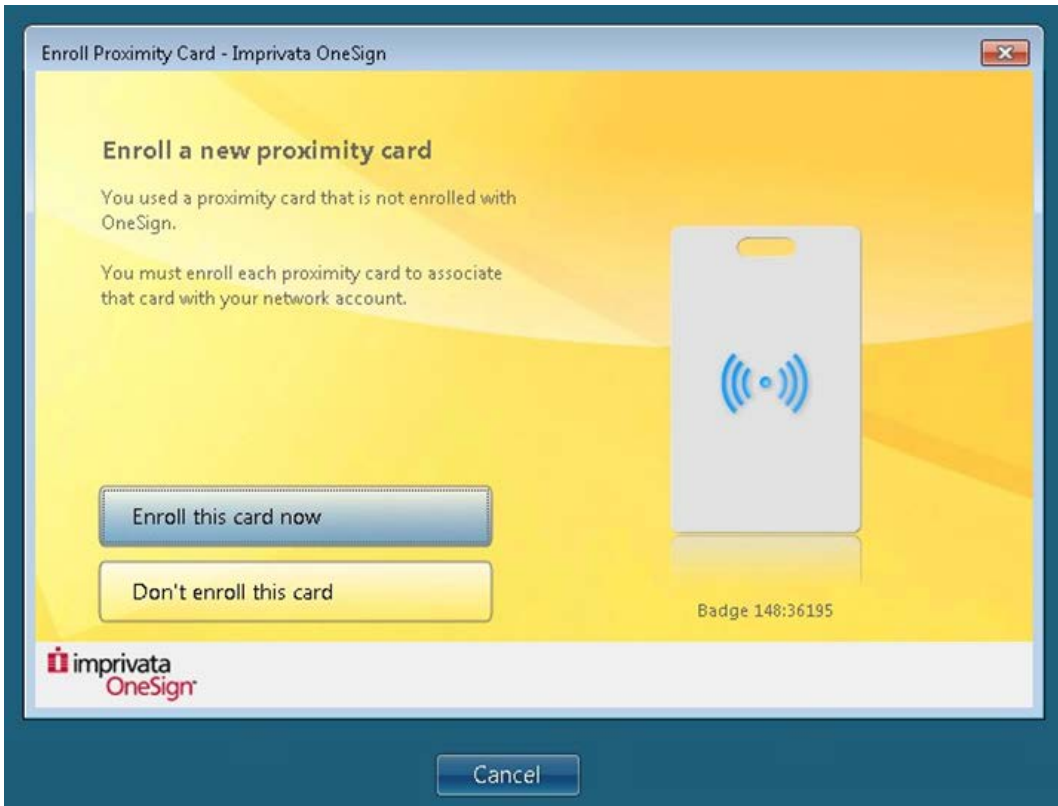

(Figure 1)

3. Click on "Enroll this card now".
4. The following screen should appear: (See fig. 2)

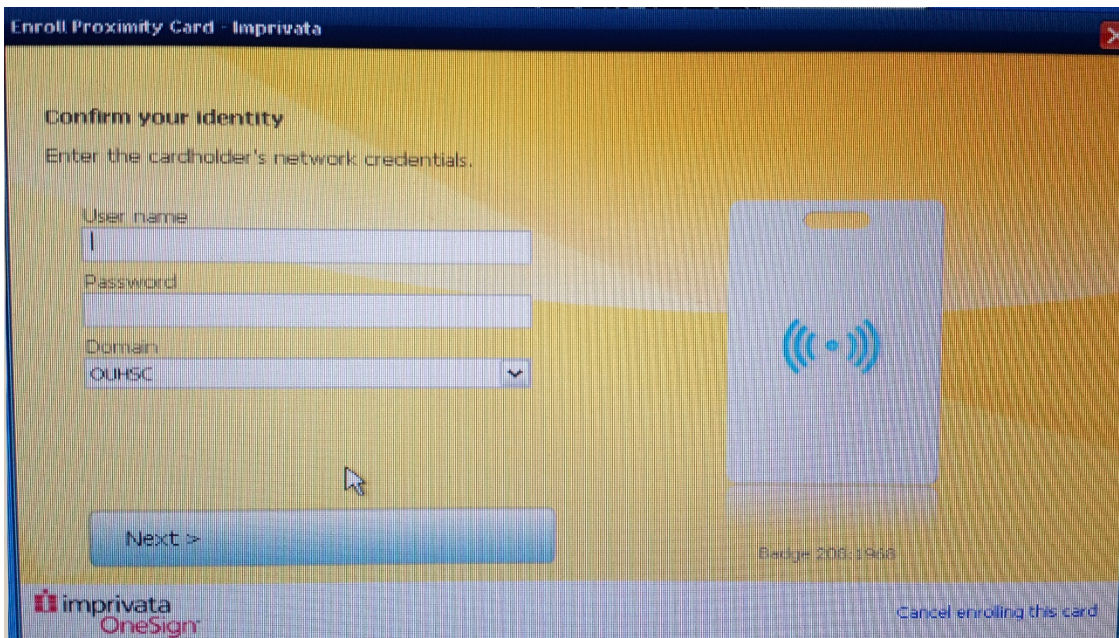

(Figure 2)

5. Enter Windows username and password in their respective fields.

6. Click Next.

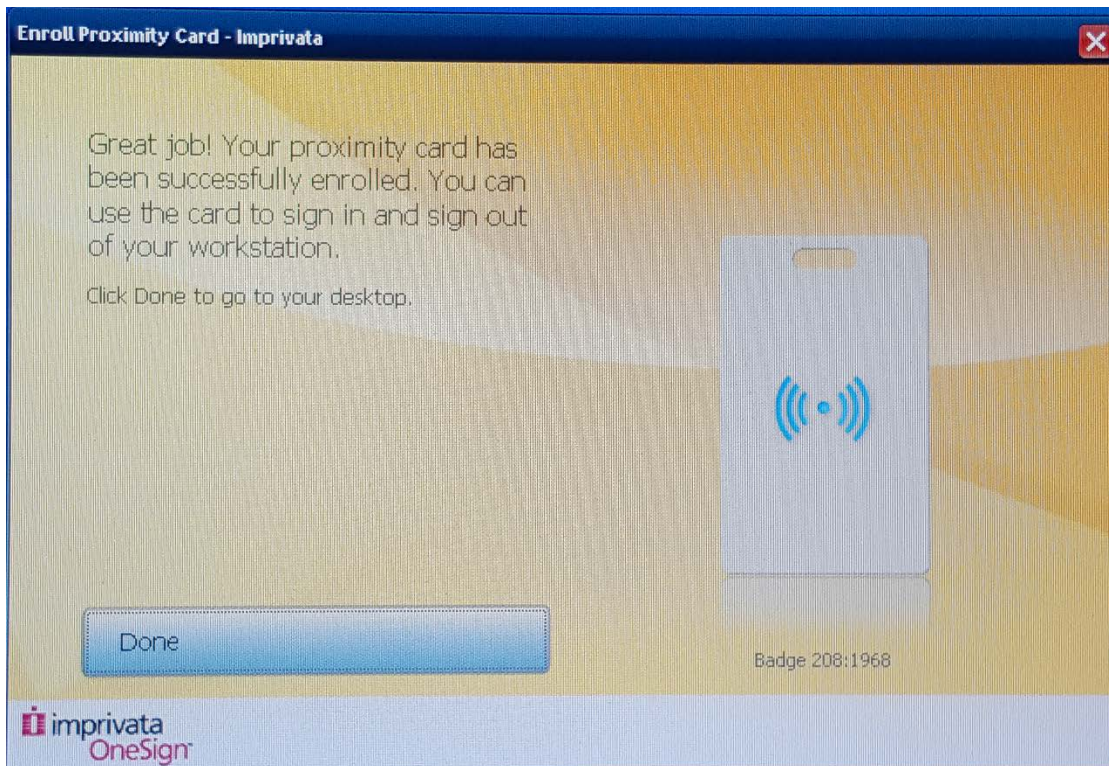

7. Click Done. The following screen should display next.

